



Area Piazza Duse



FEATURES:

Property type	Residential
Brokerage	Rent
Surface (sqm)	192
Bedrooms	3
Bathrooms	3
Energy rating	G
Floor	6
Balcony/Terrace	yes

DESCRIPTION:

Area Piazza Duse. In a charming historic building, with elegant common areas and full-day concierge service, a very high-quality residence located on floor 6°, 192 m2. **The apartment stands out for the charm of the rooms and the extraordinary brightness.** The large entrance leads to an elegant double hall with a terrace, characterised by large openings and a pleasant visual continuity with the exterior. On the opposite side of the house is the bright and well-proportioned kitchen, with access to the long **balcony that runs along the entire facade, creating a natural extension of the interior spaces.** Sleeping area is conceived as a private, quiet and sophisticated environment. The master room has 2 small balconies, large walk-in closet and elegant en suite bathroom. The property is completed by 2 more bedrooms, of which a master and a service room are served by 2 bathrooms, as well as a storage space perfectly integrated into the distribution of the house. Double exposure provides a constant natural brightness and splendid open views, with particularly evocative views of the Indro Montanelli Gardens, helping to create a rare atmosphere of quiet and respite in the heart of the city. A cellar completes the property. The apartment is rented furnished. Central heating. Air conditioning. Contract 4+4. **Annual fee € 120,000 (monthly fee €10,000) + annual expenses € ca. 10,000 (monthly expenses € ca. 800).** Energy class G. Residence of rare elegance, where light, view and value meet in one of the most sought-after addresses in the city.

Via Tommaso Salvini is the street adjacent to the refined Piazza Eleonora Duse. One of the most elegant and reserved squares in the city. Its location represents one of the most exclusive addresses in Milan. Via Tommaso Salvini and Piazza Duse are located between the Quadrilateral of Silence and Corso Venezia. In a residential setting characterized by historic buildings, embassies and prestigious residences. The Indro Montanelli Gardens are just a short walk away. Corso Venezia with high-end boutiques, restaurants and services. The area is perfectly connected thanks to the MM1 Palestro and MM1 Porta Venezia metro stops. In addition to the new M4 San Babila, which quickly connects the center with Linate Airport.

WATCH THE VIDEO <https://vimeo.com/1188035400?fl=ip&fe=ec>



Frame the QR CODE to view the property on our website



PLANIMETRY 1:

PIANO CANTINA S2

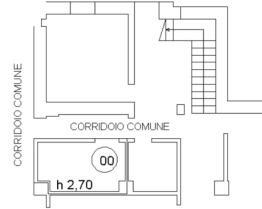

PIANO SESTO H.3.30

